

STAINLESS STEEL XD HEAVY DUTY FREE-STANDING ENCLOSURES WITH EXTERNAL DISCONNECT ENCLOSURE INSTALLED

Application

Designed to house the main power supply in external enclosure on the right side of main enclosure, keeping the live side of the power supply separate from the primary electrical equipment. Provides protection from dirt, dust, oil and water and can house most standard type disconnects. For Installation information consult our Installation Manual at www.saginawcontrol.com.

Construction

- 0.104" stainless steel Type 304.
- Seams continuously welded and ground smooth.
- Flange trough collar around all sides of door opening.
- Body stiffeners in large enclosures for extra rigidity.
- Heavy duty lifting eyes anchor into reinforced top.
- Removable center posts permit easy sub-panel installation.
- Concealed hinges.
- Black zinc die cast padlocking handles.
- 3-point latching mechanism.
- Large removable print pockets.
- Pour in place oil and water resistant gasket.
- Removable panels mount on collar studs.
- Defeater on master door requires a screwdriver to open.
- Mechanical interlock activated by the External Disconnect prevents main door of the enclosure from being closed unless the EXD enclosure is first closed.
- Mechanical interlock activated by master door prevents slave doors from being opened first. Doors can be closed in any order.
- Ground stud on door and body.
- Provisions for light kit.

Finish

#4 brushed finish on all exterior surfaces. Optional sub-panels powder coated white.

Disconnect switch (or circuit breaker) and operating mechanism are not furnished with this enclosure

IS6 Industry Standards

NEMA Type 3R, 4, 4X, 12 & Type 13
 UL Listed Type 3R, 4, 4X & 12
 CSA Type 3R, 4, 4X & 12
 IEC 60529 IP66

***To maintain Type 3R listing, Drainage is required. Install equally rated drainage device or drill a 1/8 to 1/4 inch hole in the bottom center of the enclosure, approximately 1 inch from the right, and 1 inch from the left for drainage, use listed rain-tight or wet location hubs. Drip shield over the door is recommended for all outdoor applications.

SINGLE-DOOR ENCLOSURES

304 STAINLESS STEEL

Enclosure Product Code S2					Sub-Panel (P3)		
Catalog No.	Height (A)	Width (B)	Depth (C)	Industry Standard	Catalog No.	Panel Height (D)	Panel Width (E)
SCE-72XD2818SS	72.00	27.50	18.00	IS6	SCE-64P25**	60.00	21.75
SCE-72XD3418SS	72.00	33.50	18.00	IS6	SCE-64P31**	60.00	27.75
SCE-72XD4018SS	72.00	39.50	18.00	IS6	SCE-64P37**	60.00	33.75
SCE-84XD4018SS	84.00	39.50	18.00	IS6	SCE-76P37**	72.00	33.75
SCE-90XD4018SS	90.00	39.50	18.00	IS6	SCE-82P37**	78.00	33.75

316 STAINLESS STEEL

Enclosure Product Code S2					Sub-Panel (P3)		
Catalog No.	Height (A)	Width (B)	Depth (C)	Industry Standard	Catalog No.	Panel Height (D)	Panel Width (E)
SCE-72XD2818SS6	72.00	27.50	18.00	IS6	SCE-64P25**	60.00	21.75
SCE-72XD3418SS6	72.00	33.50	18.00	IS6	SCE-64P31**	60.00	27.75
SCE-72XD4018SS6	72.00	39.50	18.00	IS6	SCE-64P37**	60.00	33.75
SCE-84XD4018SS6	84.00	39.50	18.00	IS6	SCE-76P37**	72.00	33.75
SCE-90XD4018SS6	90.00	39.50	18.00	IS6	SCE-82P37**	78.00	33.75

TWO-DOOR ENCLOSURES

304 STAINLESS STEEL

Enclosure Product Code S2					Sub-Panel (P3)		
Catalog No.	Height (A)	Width (B)	Depth (C)	Industry Standard	Catalog No.	Panel Height (D)	Panel Width (E)
SCE-72XD5418SS	72.00	53.75	18.00	IS6	SCE-64P52**	60.00	48.00
SCE-72XD6618SS	72.00	65.75	18.00	IS6	SCE-64P64**	60.00	60.00
SCE-72XD7818SS	72.00	77.75	18.00	IS6	SCE-64P76**	60.00	72.00
SCE-84XD7818SS	84.00	77.75	18.00	IS6	SCE-76P76**	72.00	72.00
SCE-90XD7818SS	90.00	77.75	18.00	IS6	SCE-82P76**	78.00	72.00

316 STAINLESS STEEL

Enclosure Product Code S2					Sub-Panel (P3)		
Catalog No.	Height (A)	Width (B)	Depth (C)	Industry Standard	Catalog No.	Panel Height (D)	Panel Width (E)
SCE-72XD5418SS6	72.00	53.75	18.00	IS6	SCE-64P52**	60.00	48.00
SCE-72XD6618SS6	72.00	65.75	18.00	IS6	SCE-64P64**	60.00	60.00
SCE-72XD7818SS6	72.00	77.75	18.00	IS6	SCE-64P76**	60.00	72.00
SCE-84XD7818SS6	84.00	77.75	18.00	IS6	SCE-76P76**	72.00	72.00
SCE-90XD7818SS6	90.00	77.75	18.00	IS6	SCE-82P76**	78.00	72.00

STAINLESS STEEL XD HEAVY DUTY FREE-STANDING ENCLOSURES WITH EXTERNAL DISCONNECT ENCLOSURE INSTALLED

THREE-DOOR ENCLOSURES

304 STAINLESS STEEL

Enclosure Product Code S2					Sub-Panel (P3)		
Catalog No.	Height (A)	Width (B)	Depth (C)	Industry Standard	Catalog No.	Panel Height (D)	Panel Width (E)
SCE-72XD3EQ18SS	72.00	99.50	18.00	IS6	SCE-64P31**	60.00	27.75
					SCE-64P37**	60.00	33.75
SCE-72XD3EW18SS	72.00	117.50	18.00	IS6	SCE-76P37**	72.00	33.75
					SCE-64P37**	60.00	33.75
SCE-84XD3EW18SS	84.00	117.50	18.00	IS6	SCE-76P37**	72.00	33.75
					SCE-76P37**	72.00	33.75

316 STAINLESS STEEL

Enclosure Product Code S2					Sub-Panel (P3)		
Catalog No.	Height (A)	Width (B)	Depth (C)	Industry Standard	Catalog No.	Panel Height (D)	Panel Width (E)
SCE-72XD3EQ18SS6	72.00	99.50	18.00	IS6	SCE-64P31**	60.00	27.75
					SCE-64P37**	60.00	33.75
SCE-72XD3EW18SS6	72.00	117.50	18.00	IS6	SCE-76P37**	72.00	33.75
					SCE-64P37**	60.00	33.75
SCE-84XD3EW18SS6	84.00	117.50	18.00	IS6	SCE-76P37**	72.00	33.75
					SCE-76P37**	72.00	33.75



**Sub-panel included with enclosure. Replacement sub-panels can be ordered.

STAINLESS STEEL XD HEAVY DUTY FREE-STANDING ENCLOSURES WITH EXTERNAL DISCONNECT ENCLOSURE INSTALLED

TECHNICAL DATA

SINGLE-DOOR ENCLOSURES

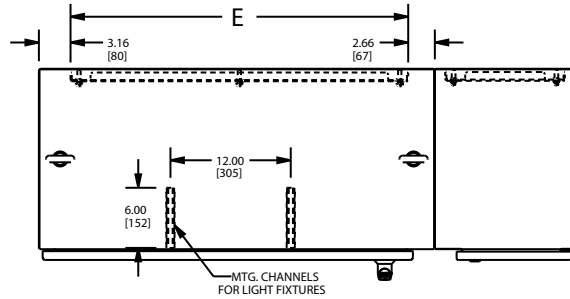

STANDARD DISCONNECTS:
 F = 0.00 [0] when A = 72.00 [1829]
 F = 5.50 [138] when A = 84.00 [2134]
 F = 8.50 [216] when A = 90.00 [2286]

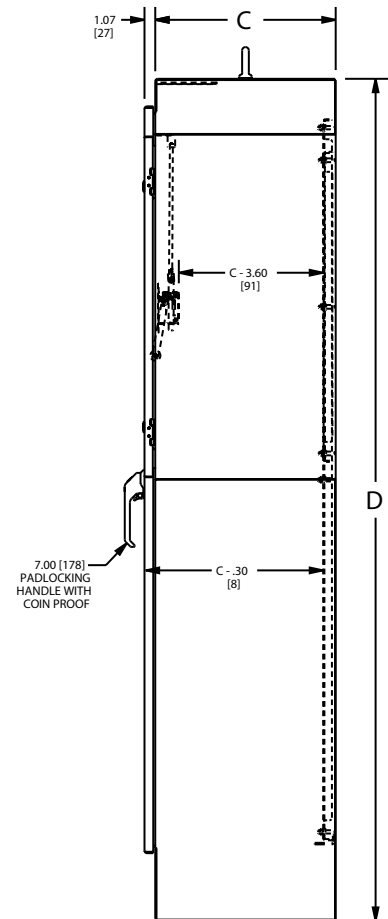
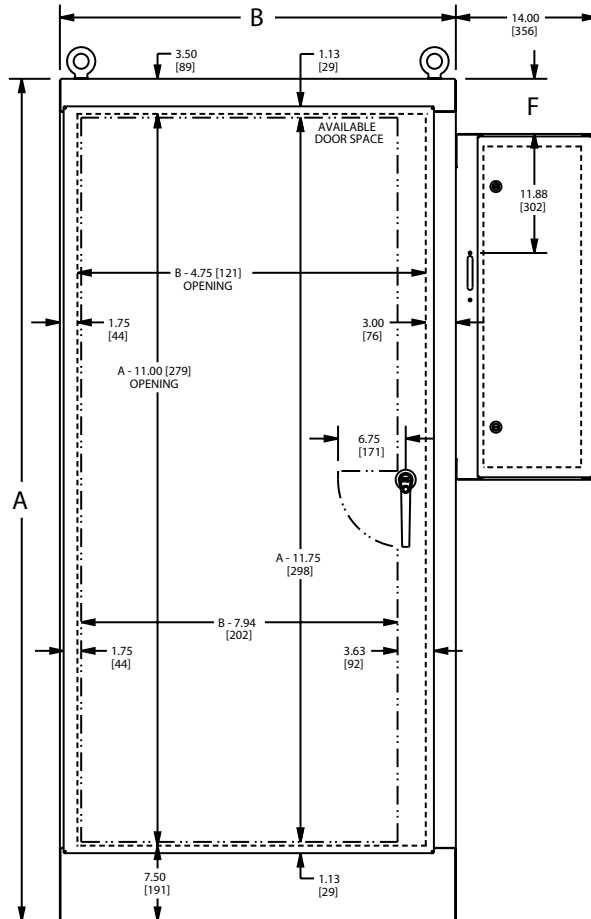

STAINLESS STEEL XD HEAVY DUTY FREE-STANDING ENCLOSURES WITH EXTERNAL DISCONNECT ENCLOSURE INSTALLED

TECHNICAL DATA

TWO-DOOR ENCLOSURES

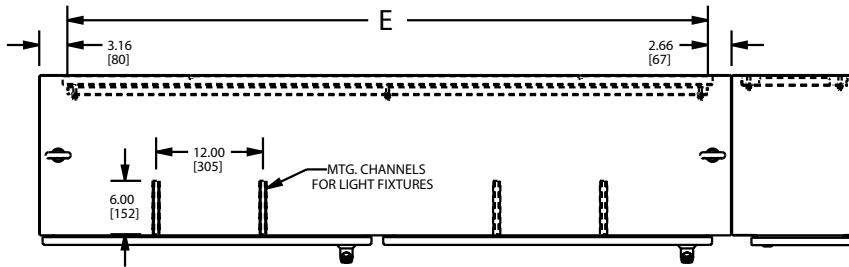

STANDARD DISCONNECTS:
 F = 0.00 [0] when A = 72.00 [1829]
 F = 5.50 [138] when A = 84.00 [2134]
 F = 8.50 [216] when A = 90.00 [2286]

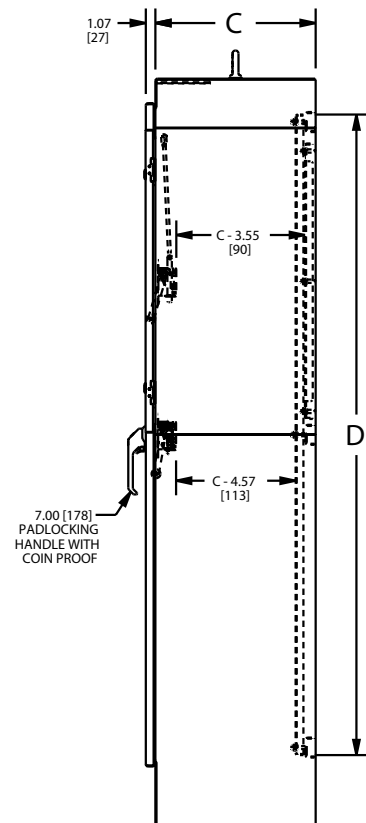
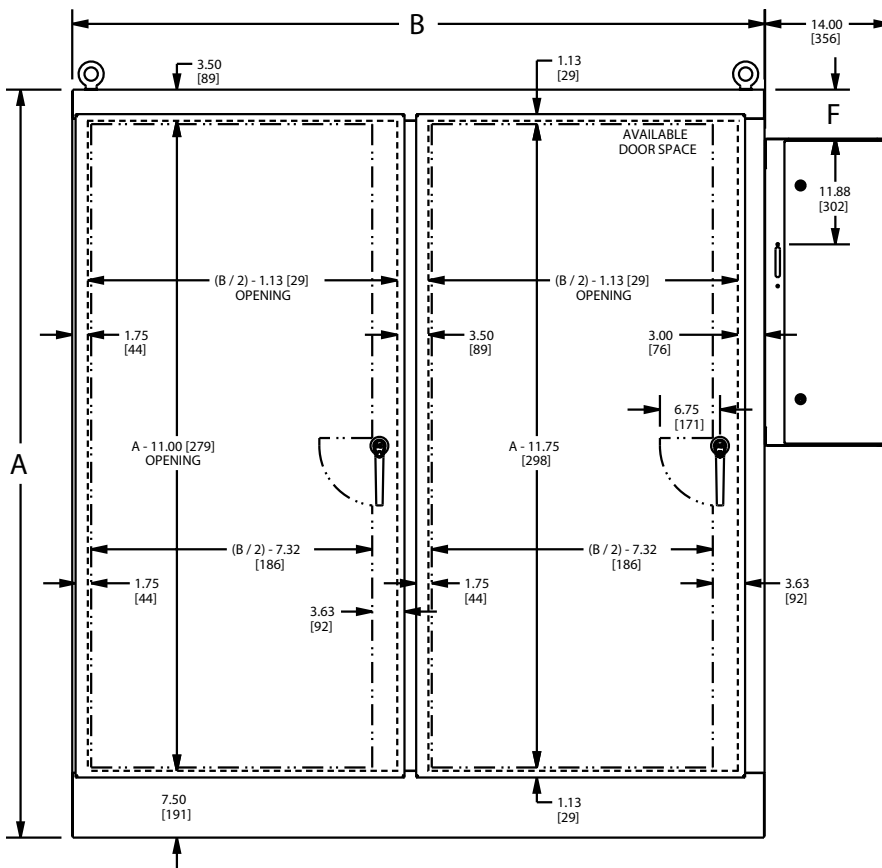

STAINLESS STEEL XD HEAVY DUTY FREE-STANDING ENCLOSURES WITH EXTERNAL DISCONNECT ENCLOSURE INSTALLED

TECHNICAL DATA

THREE-DOOR ENCLOSURES

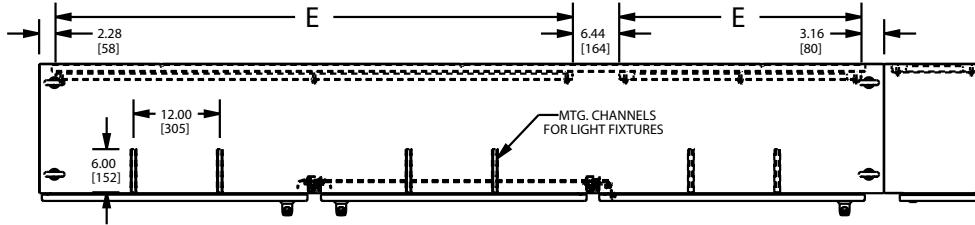

STANDARD DISCONNECTS:

F = 0.00 [0] when A = 72.00 [1829]

F = 5.50 [138] when A = 84.00 [2134]

F = 8.50 [216] when A = 90.00 [2286]

