

SAGINAW CONTROL & ENGINEERING

SCE-DLSSB

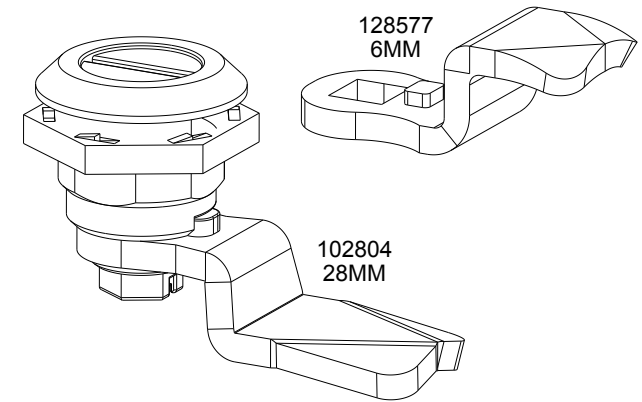

EXTERNAL CAM STOP
IS REQUIRED

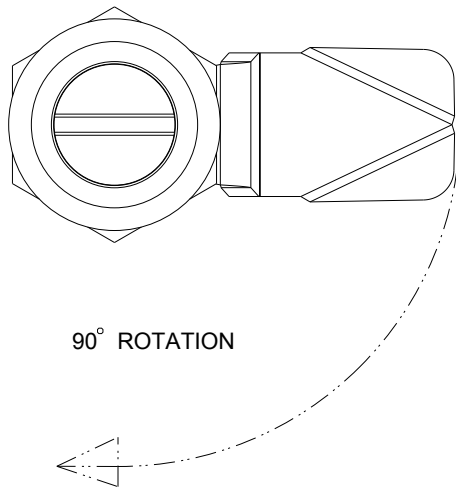
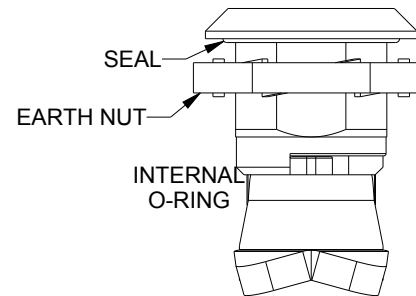
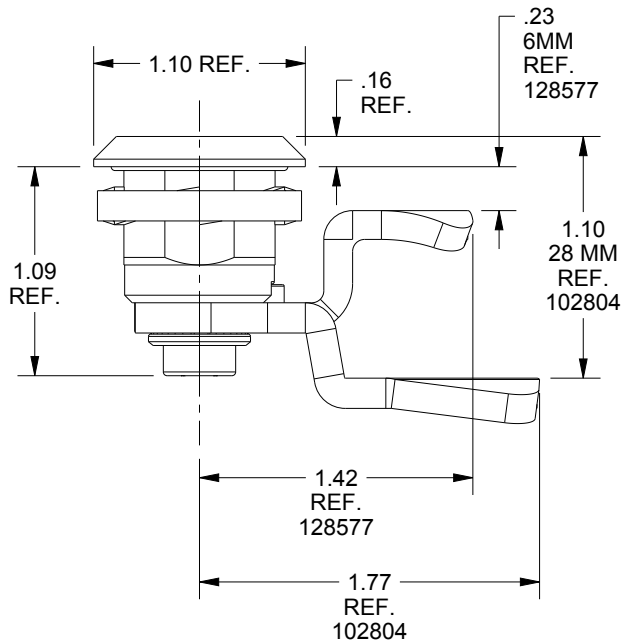

TO MAINTAIN TYPE
3, 3R, 4, 4X & 12

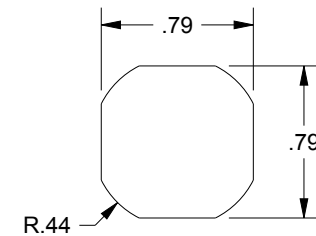

CUTOUT DETAIL

DESCRIPTION:
QUARTER TURN, SLOTTED INSERT,
EXTERNAL CAM STOP, 28MM AND 6MM CAM
INCLUDED. STAINLESS STEEL TYPE 304