



*Quality Products. Service Excellence.*

## Type 3R Mild Steel Metering Cabinets *C3RMC Series*

Hinge Door with Handle



### Application

- Designed for outdoor housing of metering transformers.

### Standards

- CSA Approved, Type 3R
- Complies with
  - NEMA Type 3R
  - IEC 60529, IP24

### Construction

- Formed and seam welded from 14 or 16 gauge steel.
- Smooth, continuously welded seams ground smooth.
- Formed lip on enclosure to exclude flowing liquids and contaminants.
- Padlockable "L" style handle for 3 point latch system
- Oil resistant gaskets are permanently secured.
- Removable inner panel included.
- Collar studs provided for mounting inner panel.
- Doors may be easily removed for modifications and are interchangeable.
- Bonding stud provided on door and grounding stud installed in enclosure.
- Hinges are constructed from 304 stainless steel.
- Hinge pins are stainless steel.

### Finish

- Cover and enclosure are phosphatized and finished with a recoatable ANSI 61 smooth Gray powder inside and out.
- Removable inner panel is finished in white powder coating.

### Accessories

- Door Stop Kit
- Mounting Foot Kit
- Drip Shield Kit

# Single Door

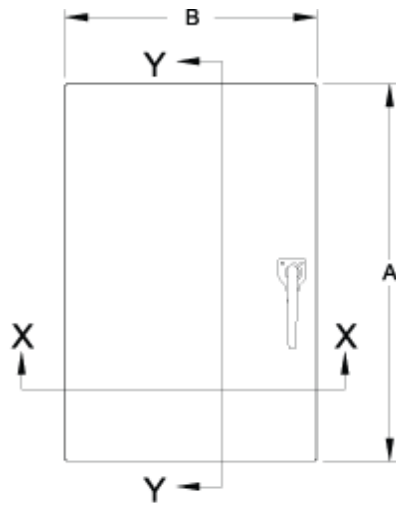

**Front View**

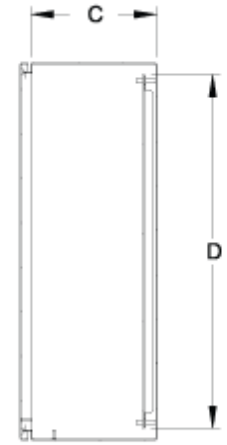

**Section Y-Y**

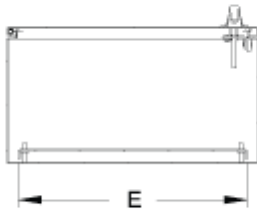

**Section X-X**

# Double Door

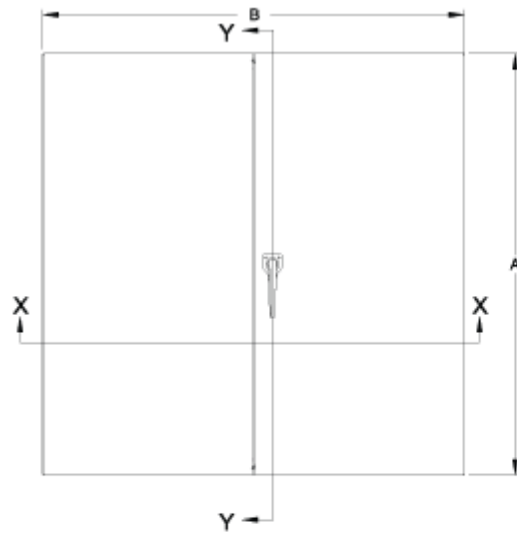

**Front View**

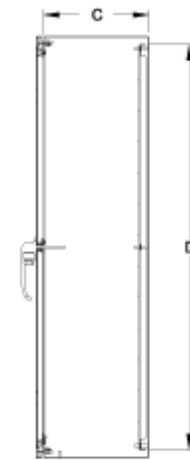

**Section Y-Y**

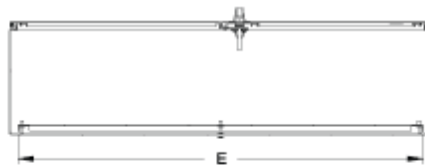

**Section X-X**

Part No.	Overall Dimensions			Panel Dimensions		Type of Door
	A	B	C	D	E	
C3RMC202010	20.00	20.00	10.00	18.17	18.17	Single
C3RMC271310	27.00	13.00	10.00	25.17	11.17	Single
C3RMC302010	30.00	20.00	10.00	28.17	18.17	Single

Part No.	Overall Dimensions			Panel Dimensions		Type of Door
	A	B	C	D	E	
C3RMC303010	30.00	30.00	10.00	28.17	28.17	Double
C3RMC363612	36.00	36.00	12.00	34.17	34.17	Double
C3RMC484812	48.00	48.00	12.00	46.17	46.17	Double

*Data subject to change without notice*

© 2018. Hammond Manufacturing Ltd. All rights reserved.