

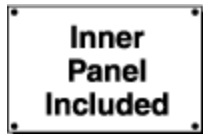

Quality Products. Service Excellence.

Type 12 Mild Steel Pushbutton Enclosures *1489 Series*

Hinged Cover



Application

- Designed to accept standard heavy duty oil tight pushbuttons, switches and pilot lights.
- Provides protection from dirt, dust, oil and water.

Standards

- UL 508A Type 12
- CSA Type 12
- JIC standard EGP-1-1967, EMP-1-1967
- **Complies with**
 - NEMA Type 12
 - IEC 60529, IP54
- Appropriate components are required to maintain these standards.

Construction

- Formed 14 gauge steel.
- Smooth continuously welded seams.
- Welded brackets provide for enclosure mounting.
- Continuously hinged cover is secured with captive, plated steel screws which fasten into threaded sealed wells.
- Oil resistant gasket and adhesive.
- Weldnuts are provided for mounting inner panels.
- A removable 14 gauge inner panel is included.
- A bonding stud is provided on the door and a grounding stud is provided in the enclosure.

Finish

- Cover and enclosure are phosphatized and finished in ANSI 61 gray powder coating.
- Removable inner panel is finished in white powder coating.

Accessories

- Hole Plugs
- Ground Wire Kits
- Pedestal and Base

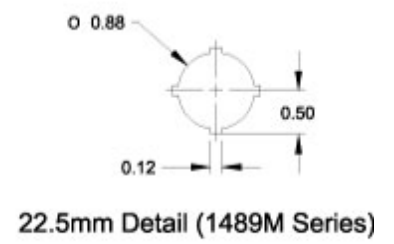
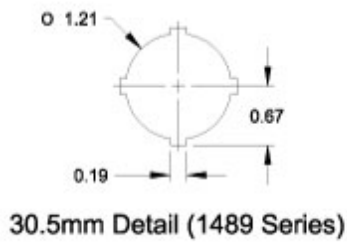
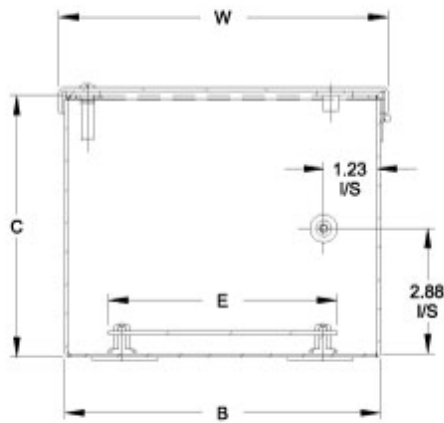
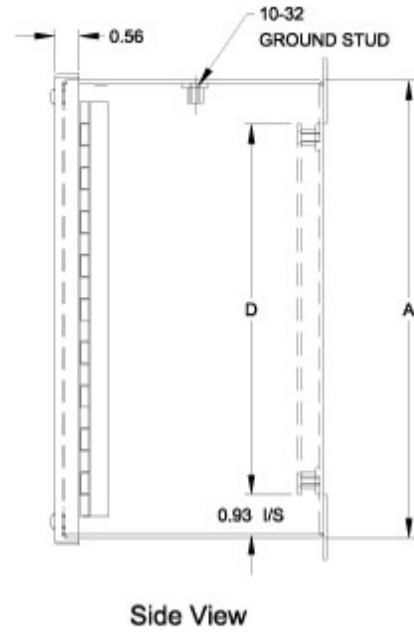
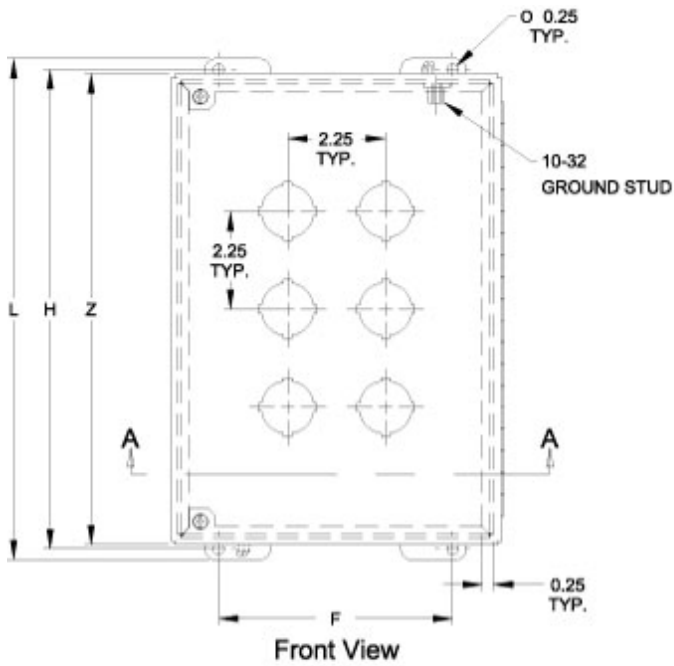

SECTION A-A

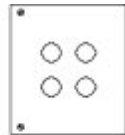

4

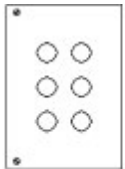

6

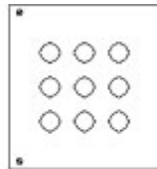

9

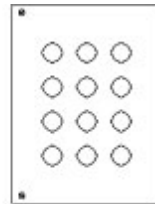

12

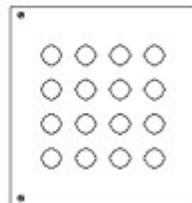

16

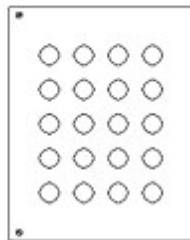

20

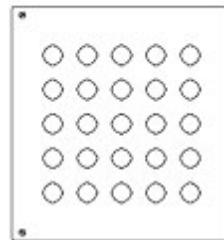

25

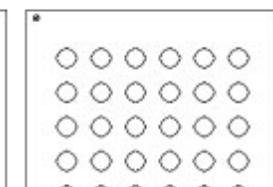
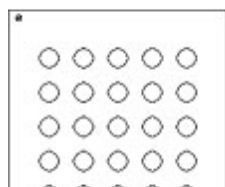

Type 12 Mild Steel Pushbutton Enclosures (1489 Series) - Hammond Mfg.

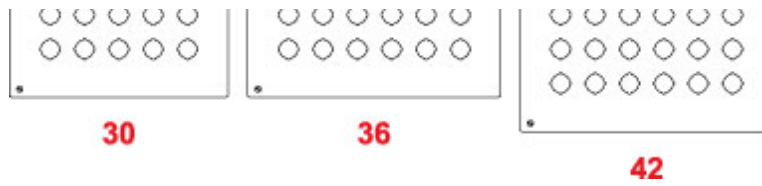

30.5mm Hole	Part No.		No. Of Holes	Panel Size							Overall Dimensions		
	22.5mm Hole			A	B	C	D	E	F	H	L	W	Z
	1489P4	1489MP4	4	8.25	7.25	6.00	6.25	5.25	5.38	8.75	9.25	7.56	8.56
	1489P6	1489MP6	6	10.50	7.25	6.00	8.50	5.25	5.38	11.00	11.50	7.56	10.81
	1489P9	1489MP9	9	10.50	9.50	6.00	8.50	7.50	7.63	11.00	11.50	9.81	10.81
	1489P12	1489MP12	12	12.75	9.50	6.00	10.75	7.50	7.63	13.25	13.75	9.81	13.06
	1489P16	1489MP16	16	12.75	11.75	6.00	10.75	9.75	9.88	13.25	13.75	12.06	13.06
	1489P20	1489MP20	20	15.00	11.75	6.00	13.00	9.75	9.88	15.50	16.00	12.06	15.31
	1489P25	1489MP25	25	15.00	14.00	6.00	13.00	12.00	12.13	15.50	16.00	14.31	15.31
	1489P30	1489MP30	30	17.25	14.00	6.00	15.25	12.00	12.13	17.75	18.25	14.31	17.56
	1489P36	1489MP36	36	17.25	16.25	6.00	15.25	14.25	14.38	17.75	18.25	16.56	17.56
	1489P42	1489MP42	42	19.50	16.25	6.00	17.50	14.25	14.38	20.00	20.50	16.56	19.81

Data subject to change without notice

© 2018. Hammond Manufacturing Ltd. All rights reserved.